



ALCOHOL LICENSE PUBLIC HEARING AUGUST 26, 2024

ALPHARETTA CITY CLERK'S OFFICE
VIRTUAL MEETING VIA ZOOM

CITY CLERK: LSHAPIRO@ALPHARETTA.GA.US
ASSISTANT CITY CLERK: KVANHORN@ALPHARETTA.GA.US

2:00 PM

I. VIRTUAL MEETING ZOOM LINK

The City of Alpharetta's Alcohol License Public Hearings are a virtual meeting via Zoom. The meeting begins at 2:00 p.m. on the day of the scheduled hearing. To join the meeting, please click on this link: <https://zoom.us>

Zoom Meeting ID: 835 7343 3263

II. CALL TO ORDER

- City Clerk Lauren Shapiro called the meeting to order at 2:03 p.m.

III. ROLL CALL

- Lauren Shapiro, City Clerk
- Kiersten VanHorn, Assistant City Clerk
- Jacob O'Donnell, Code Enforcement Supervisor
- Xinyue Yin, Owner of and registered agent for Samurai Restaurant Group LLC
- Kyle Baker, English Taylor Duma LLP attorney representing Rohm Group, LLC
- Ketankumar Patel, co-owner Rohm Group, LLC

IV. PUBLIC HEARING

**A. PH-24-AB-15 Samurai Restaurant Group, LLC
d/b/a Edo Japanese Cuisine
2500 North Point Court
Alpharetta, GA 30022**

**Eating Establishment
Consumption on Premises
Distilled Spirits, Beer, Wine & Sunday Sales**

**Owner: Samurai Restaurant Group, LLC
Registered Agent: Xinyue Yin**

- Mr. Xinyue Yin, owner of and registered agent for Samurai Restaurant Group, LLC d/b/a , and residing at 1053 Wild Dunes Way, Johns Creek, GA 30087, was on the call.
- Mr. Yin stated the restaurant will serve Japanese style cuisine including sushi, sashimi and yakitori. This is a new restaurant.
- Mr. Yin stated he anticipates the restaurant will open in late October/early November.
- Mr. Yin stated there he is familiar with the City of Alpharetta's alcohol ordinances and employees will have a pouring permit.
- Officer O'Donnell confirmed that City staff has reviewed the application and that it meets all the City's requirements for an alcohol license. Ms. Shapiro recommended the application be approved and advised the applicant that a representative will need to appear in person at the

Alpharetta City Council meeting on Monday, September 9, 2024, at 6:30 pm in case Mayor or Council have any questions.

B. PH-24-AB-16 Rohm Group, LLC

d/b/a Hampton Inn & Suites

10740 Westside Way, Alpharetta, GA 30009

Hotel

Consumption on Premises and Specialty Gift Shop

Beer, Wine & Sunday Sales

Owner: Rohm Group, LLC

Registered Agent: Riviere Duffy

- Mr. Kyle Baker, attorney at English Taylor Duma LLP at 1600 Parkwood Circle, Suite 200, Atlanta, GA 30339 was on the call representing the applicant. Mr. Ketan Patel, co-owner of Rohm Group, LLC and residing at 3120 Pope Manor Circle, Marietta, GA 30062, was also on the call.
- Mr. Baker stated that the individuals involved in the new entity will be taking over ownership but had shared in the ownership previously. There will not be any real change in staff or day-to-day operations at the hotel.
- Mr. Baker stated the change took place on August 13, 2024.
- Mr. Baker asked a question about which employees are required to have pouring permits as they are providing package sales in the gift shop and not serving/pouring. Ms. Shapiro and Officer O'Donnell provided clarification. Officer O'Donnell will send a Code Enforcement check list to Mr. Patel to list what is looked for during on site inspections by the City.
- Ms. Shapiro advised Mr. Patel that establishments are encouraged to provide some type of alcohol service training to their employees, whether it is through an alcohol service training program or a corporate training program.

V. PUBLIC COMMENT

- There were no public comments.

VI. ADJOURNMENT

- **City Clerk Lauren Shapiro adjourned the hearing at 2:21 p.m.**

Respectfully submitted,

Kiersten VanHorn

Kiersten VanHorn, Assistant City Clerk



CITY OF ALPHARETTA

REPORT FOR SURVEY FOR ALCOHOLIC BEVERAGE LICENSE

TO: Alcoholic Beverage Permitting - Department of Community Development

DATE: July 22, 2024

APPLICANT: Xinyue Yin

TRADE NAME: EDO Japanese Cuisine

ADDRESS: 2500 North Point Court

CITY: Alpharetta

STATE: GA



ZIP: 30022

The undersigned has examined the subject location and has made measurements to determine the compliance or noncompliance with distance requirement of the Code Of The City Of Alpharetta, Georgia, as follows:

1. 4925 feet to the Residence
(private) residence located at 225 Summerfield Drive, Alpharetta, GA 30022

2. 3584 feet to the School Bus Stop
(regular) school bus stop as designated by the Fulton County Board of Education** where five (5) or more children board the bus and which is located at Mill Creek Avenue and Cicero Drive

** This information can be obtained by faxing your request to "North Transportation; Fulton Board of Education" at 470-254-2978. List type of application applied for, name of company, owner of company, street address, your phone number, and name and information requested.

Distance requirements are defined in Section 4-17 and Section 4-398 of the Code of the City of Alpharetta.

3. 11088 feet to the Saehan Presbyterian Church
(church or other place used primarily for religious service) located at 3385 Kimball Bridge Rd, Alpharetta, GA 30022

4. 1.9 Miles feet to the Alpharetta Branch Library
(public library or branch thereof) located at 10 Park Plaza, Alpharetta, GA 30009

5. 2907 feet to the New Prospect Elementary School
(school ground or college campus) located at 3055 Kimball Bridge Rd, Alpharetta, GA 30022

6. 1.3 Miles feet to the Rock Mill Park
(portion of public park habitually used for recreational purposes) located at 3100 Kimbell Bridge Rd, Alpharetta, GA 30022

Distance requirements are defined in Section 4-17 and Section 4-398 of the Code of the City of Alpharetta. Please review these sections of the City Code prior to executing this document below. Any distance requirements required by State of Georgia law, such as the minimum distance between package stores, must also be shown on the survey.

In my opinion, the premises indicated above meets the distance requirements for licensing as prescribed by the Code of the City of Alpharetta, Georgia.

Elvin Aycock

Signature of Georgia Registered Land Surveyor

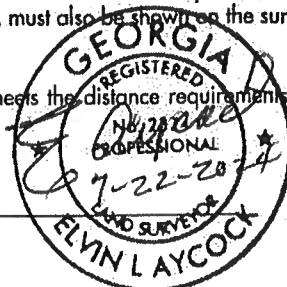

2374

Surveyor Number

NOTE: A survey showing the distance to the use described above must be attached to this form at the time of submittal.

ATLANTA ENGINEERING SERVICES, INC. HAS NOT PERFORMED A BOUNDARY LINE SURVEY AS PER THE GEORGIA PLAT ACT O.C.G.A. 15-6-67.

ATLANTA ENGINEERING SERVICES

918 HOLCOMB BRIDGE ROAD, SUITE 201
 ROSWELL, GEORGIA 30076
 PHONE: 770-316-1720

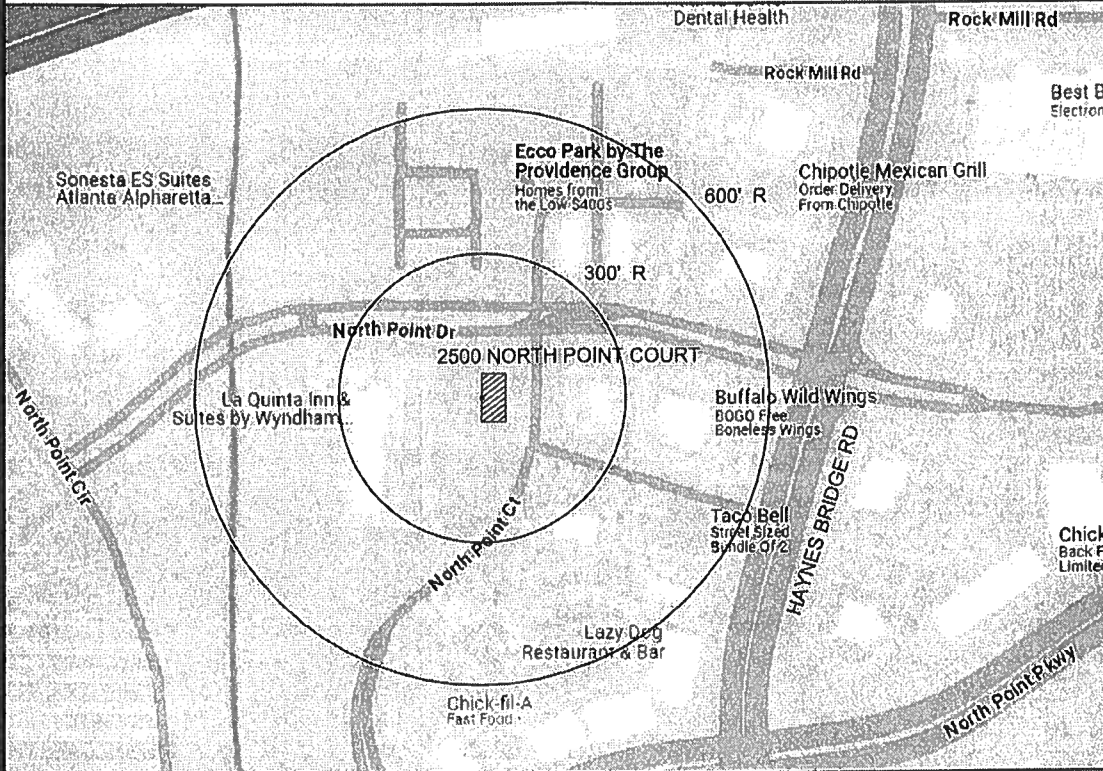

DISTANCE MEASUREMENTS:

SCHOOL / SCHOOL GROUNDS:
 NEW PROSPECT ELEMENTARY SCHOOL
 3055 KIMBALL BRIDGE RD, ALPHARETTA, GA 30022
 2907' TO SCHOOL GROUNDS MEASURED IN A DIRECT ROUTE OF TRAVEL

CHURCH: SAEHAN PRESBYTERIAN CHURCH
 3385 KIMBALL BRIDGE RD, ALPHARETTA, GA 30022
 11088' MEASURED IN A DIRECT ROUTE OF TRAVEL

PACKAGE STORE: TOTAL WINE & MORE
 6290 NORTH POINT PARKWAY, ALPHARETTA, GA 30022
 2644' MEASURED IN A DIRECT ROUTE OF TRAVEL

LIBRARY: ALPHARETTA BRANCH LIBRARY
 10 PARK PLAZA, ALPHARETTA, GA 30009
 1.9 MILES MEASURED IN A DIRECT ROUTE OF TRAVEL

RESIDENTIAL:
 225 SUMMERFIELD DRIVE, ALPHARETTA, GA 30022
 4925' MEASURED IN A DIRECT ROUTE OF TRAVEL

PUBLIC PARK: ROCK MILL PARK
 3100 KIMBALL BRIDGE RD, ALPHARETTA, GA 30022
 1.3 MILES MEASURED IN A DIRECT ROUTE OF TRAVEL

SCHOOL BUS STOP:
 MILL CREEK AVE & CICERO DRIVE
 ALPHARETTA, GA 30022
 3584' MEASURED IN A DIRECT ROUTE OF TRAVEL

ALCOHOLIC LICENSE SURVEY FOR:

OWNER: XINYUE YIN
 2500 NORTH POINT COURT
 ALPHARETTA, GA 30022

Business name: EDO JAPANESE CUISINE
Site Address: 2500 NORTH POINT COURT
 ALPHARETTA, GA 30022

NO RESPONSIBILITY OR LIABILITY IS ASSUMED BY ATLANTA ENGINEERING SERVICES, INC. OR USE OF SURVEY FOR ANY OTHER PURPOSE INCLUDING, BUT NOT LIMITED TO USE OF SURVEY FOR SURVEY AFFIDAVIT, RESALE OF PROPERTY, OR TO ANY OTHER PERSON NOT LISTED IN CERTIFICATION, EITHER DIRECTLY OR INDIRECTLY.

GENERAL NOTES:

1. THIS MAP IS A SPECIAL PURPOSE MAP INTENDED FOR SOLE USE OF THE OWNER.
2. ALL MATTERS OF TITLE ARE EXCEPTED.
3. THIS PLAT IS NOT FOR RECORDING.
4. EQUIPMENT USED FOR MEASUREMENTS: SURVEY MEASURING WHEEL AND GOOGLE EARTH.
5. DISTANCES MEASURED IN A DIRECT ROUTE OF TRAVEL.

FULTON COUNTY
 STATE OF GEORGIA

JOB. NO. 2024-3475
 SCALE: AS NOTED
 DWN. BY: ELA
 FIELD WORK: 07-19-2024
 DATE DRAFTED: 07-22-2024
 REVISION:

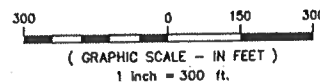
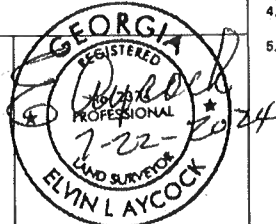



CITY OF ALPHARETTA
REPORT FOR SURVEY FOR
ALCOHOLIC BEVERAGE LICENSE

TO: Alcoholic Beverage Permitting - Department of Community Development

DATE: _____

APPLICANT: Rohm Group, LLC

TRADE NAME: Hampton Inn & Suites

ADDRESS: 10740 Westside Way CITY: Alpharetta STATE: GA ZIP: 30009

The undersigned has examined the subject location and has made measurements to determine the compliance or noncompliance with distance requirement of the Code Of The City Of Alpharetta, Georgia, as follows:

1. 1.07 miles feet to the Residence
(private) residence located at 1100 Rappahannock Drive Roswell, GA 30076

2. 3896 feet to the School Bus Stop
[regular] school bus stop as designated by the Fulton County Board of Education** where five (5) or more children board the bus and which is located at Huntington Road & Governors Circle

** This information can be obtained by faxing your request to "North Transportation: Fulton Board of Education" at 470-254-2978. List type of application applied for, name of company, owner of company, street address, your phone number, and name and information requested.

Distance requirements are defined in Section 4-17 and Section 4-398 of the Code of the City of Alpharetta.

3. 1063 feet to the Roswell Community Church
(church or other place used primarily for religious service) located at 100 Mansell Rd, Roswell, GA 30076

4. 403 miles feet to the Alpharetta Branch Library
(public library or branch thereof) located at 10 Park Plaza Alpharetta, GA 30009

5. 6117 feet to the Mimosa Elementary School
[school ground or college campus] located at 1550 Warsaw Road Roswell, GA 30076

6. 1.2 miles feet to the Green Walk Trail
[portion of public park habitually used for recreational purposes] located at Beaver Creek Rd Alpharetta, GA 30009

Distance requirements are defined in Section 4-17 and Section 4-398 of the Code of the City of Alpharetta. Please review these sections of the City Code prior to executing this document below. Any distance requirements required by State of Georgia law, such as the minimum distance between package stores, must also be shown on the survey.

In my opinion, the premises indicated above meets the distance requirements for licensing as prescribed by the Code of the City of Alpharetta, Georgia.

[Handwritten signature]

Signature of Georgia Registered Land Surveyor



2374
Surveyor Number

NOTE: A survey showing the distance to the use described above must be attached to this form at the time of submittal.

ATLANTA ENGINEERING SERVICES, INC. HAS NOT PERFORMED A BOUNDARY LINE SURVEY AS PER THE GEORGIA PLAT ACT O.C.G.A. 15-6-67.

ATLANTA ENGINEERING SERVICES

918 HOLCOMB BRIDGE ROAD, SUITE 201
 ROSWELL, GEORGIA 30076
 PHONE: 770-316-1720

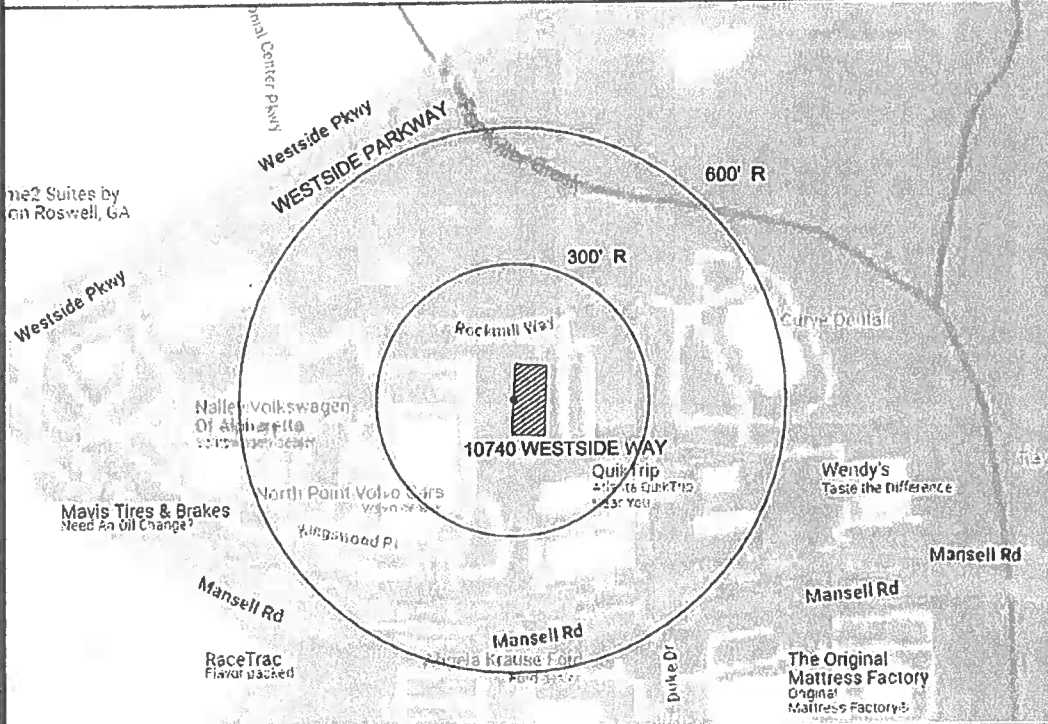

DISTANCE MEASUREMENTS:

SCHOOL / SCHOOL GROUNDS:
 MIMOSA ELEMENTARY SCHOOL
 1550 WARSAW ROAD, ROSWELL, GA 30076
 5117' TO SCHOOL GROUNDS MEASURED IN A DIRECT ROUTE OF TRAVEL

CHURCH: ROSWELL COMMUNITY CHURCH
 100 MANSELL ROAD, ROSWELL, GA 30076
 1063' MEASURED IN A DIRECT ROUTE OF TRAVEL

PACKAGE STORE: ALPHA DOG BEER & WINE
 900 MANSELL OAKS PLAZA, ROSWELL, GA 30076
 1.45 MILES MEASURED IN A DIRECT ROUTE OF TRAVEL

LIBRARY: ALPHARETTA BRANCH LIBRARY
 10 PARK PLAZA, ALPHARETTA, GA 30009
 4.03 MILES MEASURED IN A DIRECT ROUTE OF TRAVEL

RESIDENTIAL:
 1100 RAPPAHANNOCK DRIVE, ROSWELL, GA 30076
 1.07 MILES MEASURED IN A DIRECT ROUTE OF TRAVEL

PUBLIC PARK: GREEN WALK TRAIL
 BEAVER CREEK ROAD, ALPHARETTA, GA 30009
 1.2 MILES MEASURED IN A DIRECT ROUTE OF TRAVEL

SCHOOL BUS STOP:
 HUNTINGTON ROAD & GOVERNORS CIRCLE
 ALPHARETTA, GA 30004
 3896 MILES MEASURED IN A DIRECT ROUTE OF TRAVEL

ALCOHOLIC LICENSE SURVEY FOR:

OWNER: ROHM GROUP, LLC
 10740 WESTSIDE WAY
 ALPHARETTA, GA 30009

Business name: HAMPTON INN & SUITES
Site Address: 10740 WESTSIDE WAY
 ALPHARETTA, GA 30009

NO RESPONSIBILITY OR LIABILITY IS ASSUMED BY ATLANTA ENGINEERING SERVICES, INC. OR USE OF SURVEY FOR ANY OTHER PURPOSE INCLUDING, BUT NOT LIMITED TO USE OF SURVEY FOR SURVEY AFFIDAVIT, RESALE OF PROPERTY, OR TO ANY OTHER PERSON NOT LISTED IN CERTIFICATION, EITHER DIRECTLY OR INDIRECTLY.

GENERAL NOTES:

1. THIS MAP IS A SPECIAL PURPOSE MAP INTENDED FOR SOLE USE OF THE OWNER.
2. ALL MATTERS OF TITLE ARE EXCEPTED.
3. THIS PLAT IS NOT FOR RECORDING.
4. EQUIPMENT USED FOR MEASUREMENTS: SURVEY MEASURING WHEEL AND GOOGLE EARTH
5. DISTANCES MEASURED IN A DIRECT ROUTE OF TRAVEL.

FULTON COUNTY
 STATE OF GEORGIA

JOB NO. 2024-3434
 SCALE: AS NOTED
 DWN. BY: ELA
 FIELD WORK: 04-08-2024
 DATE DRAFTED: 04-09-2024
 REVISION:

